

S5-50/90, S6-65/66/70/75/80/90, 6S-800/1000/1005/1200
TD/TO (Volvo ZTO 1006), 6AS 800/1000TO

Posterior Neumático Reforzado, girado
Rear Pneumatic Heavy Duty, Rotated

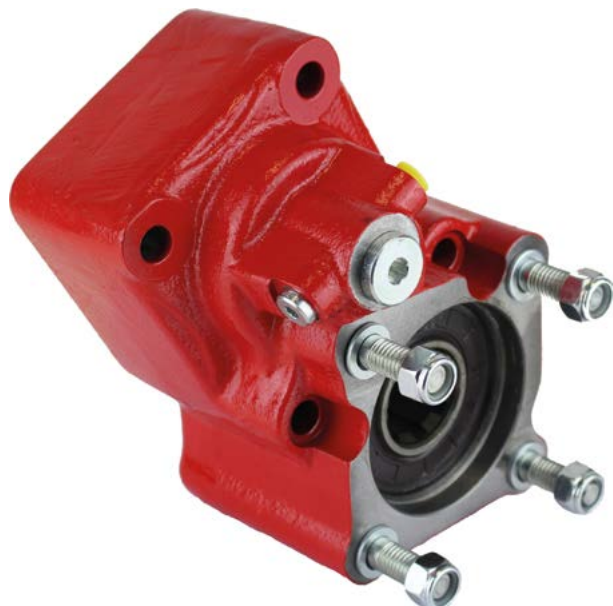

Descripción Description

Toma de fuerza con 5º tornillo adicional para mejor sujeción de bombas pesadas (ZF Ecosplit, Astronic, TraXon) con nuestras bridas integradas. Accionamiento neumático, salida girada (bombas ISO 4 taladros). Diferentes relaciones internas. Indicador de funcionamiento opcional de bayoneta o presostato.

Rear PTO with a 5th additional bolt for a better support with heavy pumps (ZF Ecosplit, Astronic and TraXon) through our integrated flanges. Pneumatic shifting ISO 4 bolts pump rotated output.

Datos Principales		Main Data		
Relación Interna Internal Ratio		1: 1.8	1: 1.5	1: 1.3
Par nominal Torque (Nm)	Continuo Continuous	350	400	450
	Intermitente Intermittent	490	560	630
Potencia (1500 r.p.m.) Power (HP) 1500 r.p.m		75 C.V. // 56 Kw	87 C.V. // 65 Kw	97 C.V. // 72 Kw
Lado de montaje Mounting position		Posterior Rear		
Sentido de giro de la bomba Pump rotation		Derecho ClockWise		
Peso Weight (Kg)		11,45		
Relación motor - Toma de Fuerza Engine to PTO ratio		ANEXO I ATTACHMENT I	ANEXO II ATTACHMENT II	ANEXO III ATTACHMENT III

Códigos y Combinaciones		Part Numbers and Combinations	
Tipos de salida Output types		Plato Flange	Bomba Pump (DIN 5462)
Relación Interna Internal Ratio	1: 1.8	102K002	102K003
	1: 1.5	102K102	102K103
	1: 1.3	102K202	102K203

S5-50/90, S6-65/66/70/75/80/90, 6S-800/1000/1005/1200
 TD/TO (Volvo ZTO 1006), 6AS 800/1000TO

Posterior Neumático Reforzado, girado Rear Pneumatic Heavy Duty, Rotated

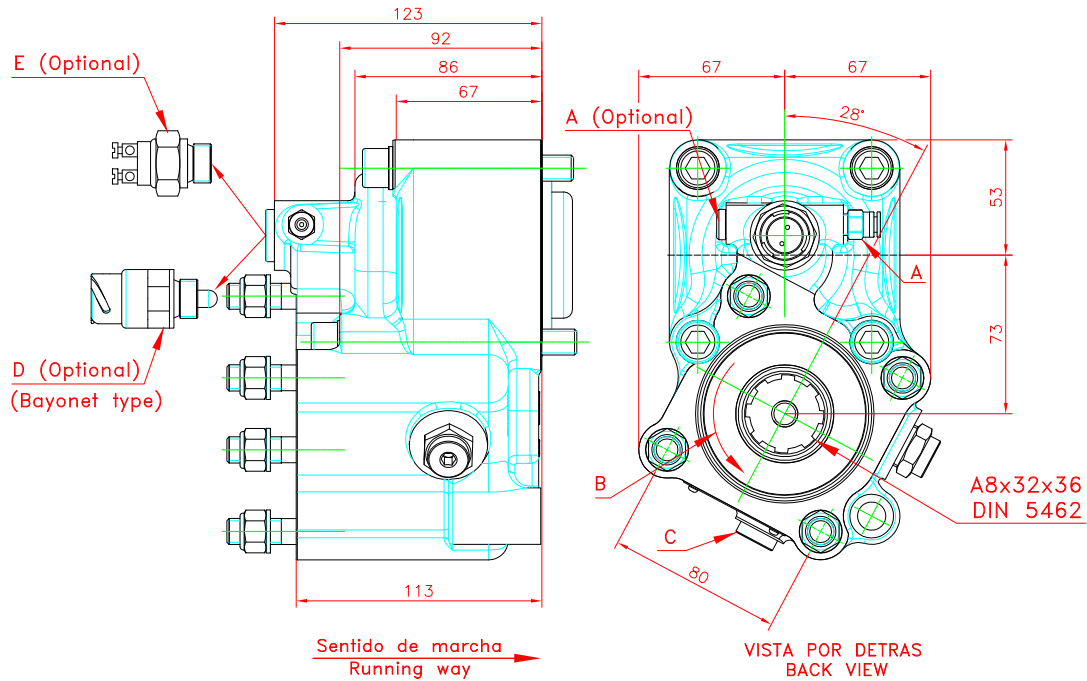

Notas Notes

A	Toma de aire, rosca 1/8" GAS.	A	Air connection, thread BSP 1/8"
B	Sentido de giro.	B	Rotation.
C	Tapón de drenaje.	C	Oil drain plug.
D	Interruptor de contacto opcional (9024999)	D	Passing contact switch (Optional) P/N 9024999
E	Interruptor neumático opcional (100070018)	E	Pressure switch (Optional) P/N 100070018

Tipos de Salida Output Types

Kits conversión a Plato / Drive Flange conversion Kits

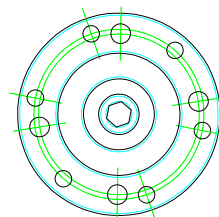
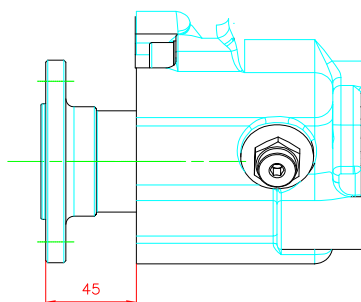

P/N.	906815	906915	907015
SAE	1100	1300	1400

P/N.	907115	907215	907315
DIN	90	100	120

S5-50/90, S6-65/66/70/75/80/90, 6S-800/1000/1005/1200
TD/TO (Volvo ZTO 1006), 6AS 800/1000TO

Posterior Neumático Reforzado, girado
Rear Pneumatic Heavy Duty, Rotated

Anexo I Attachment I

	CAJA GEARBOX	RELACIÓN RATIO
S5-50	/ 5.30	1,175
	/ 5.50	1,107
	/ 6.20	0,981
	/ 6.61	0,918
	/ 6.61+GV80	Larga High 1,147
	/ 5.30	Normal 0,918
	/ 8.02	0,76
	/ 8.02+GV80/6.20	Larga High 0,981
		Normal 0,758
	S5-90GP	/ GPA
/ 6.37		1,17
/ 6.70		1,116
/ 7.0+GV70/7.67		Larga High 0,821
		Normal 0,657
S6-65	/ 7.40	1,012
	/ 7.52	0,999
	/ 9.00	0,832
	/ 7.97+GV80/6.70	Larga High 1,116
		Normal 0,945
	/ 9.00+GV80/6.70	Larga High 1,116
		Normal 0,832
	/ 9.00+GV80/7.52	Larga High 0,997
		Normal 0,832
	S6-66	/ 7.36-1.0
/ 9.06-1.0		0,749
/ 6.8		0,925
/ 6.8+GV70/5.71		Larga High 1,102
S6-70		Normal 0,925
	/ 7.36	0,86
	/ 7.92	0,794
	/ 9.03	0,697
	/ 9.59	0,657
S6-75	/ 6.70+GV80/7.52	Normal 1,116
		Corta Low 0,997
S6-80	/ 5.03	1,404
	/ 5.66	1,332

	CAJA GEARBOX	RELACIÓN RATIO
S6-80	/ 5.66+GV80/7.52	Larga High 1,328
		Normal 1,001
	/ 6.10	1,238
	/ 6.7	1,116
	/ 6.7+GV80/5.30	Larga High 1,417
		Normal 1,116
	/ 6.90	0,927
	/ 7.35	0,994
	/ 7.41	1,013
	/ 7.53	0,999
S6-90	/ 7.67	0,972
	/ 7.67+GV80/6.7	Larga High 1,12
		Normal 0,977
	/ 7.90	0,945
	/ 9.00	0,828
	/ 9.00+GV80/5.30	Larga High 1,417
		Normal 0,832
	/ 9.00+GV80/7.48	Larga High 1,012
		Normal 0,832
	/ 9.00+GV80/7.52	Larga High 0,997
	Normal 0,832	
6S-800/1000/1005/1200 TD/TO (Volvo ZTO 1006)	/5.67	1,35
	/5.74	1,332
	/6.37	1,332
	/6.98	1,102
	/7.03	1,085
	/ 7.03+GV90/5.67	Larga High 1,35
		Normal 1,085
	/ 7.03+GV90/5.74	Larga High 1,323
		Normal 1,08
	/7.40	1,035
/ 9.01	0,846	
6AS 800/1000TO	/ 9.01+GV90/7.40	Larga High 1,031
		Normal 0,848
	6S800TO/6.58-0.78 (Volvo ZTO 1006)	0,954
	6AS 800 TO/6.58-0.78	0,954
	6AS1000TO/6.75-0.78	0,954
6S1000/1005 TO/6.75 - 0.78	0,954	
6S1200TD/7.72 - 1.00	0,972	
6S1200TO/6.75 - 0.83	1,116	

S5-50/90, S6-65/66/70/75/80/90, 6S-800/1000/1005/1200
TD/TO (Volvo ZTO 1006), 6AS 800/1000TO

Posterior Neumático Reforzado, girado
Rear Pneumatic Heavy Duty, Rotated

Anexo II Attachment II

	CAJA GEARBOX	RELACIÓN RATIO		CAJA GEARBOX	RELACIÓN RATIO
	/ 5.30	1: 0,979			
	/ 5.50	1: 0,923		/ 5.66+GV80/7.52	Larga High 1: 1,107 Normal 1: 0,834
	/ 6.20	1: 0,818		/ 6.10	1: 1,032
	/ 6.61	1: 0,765		/ 6.7	1: 0,93
S5-50	/ 6.61+GV80	Larga High 1: 0,956		/ 6.7+GV80/5.30	Larga High 1: 1,181 Normal 1: 0,93
	/ 5.30	Normal 1: 0,765		/ 6.90	1: 0,773
	/ 8.02	1: 0,633		/ 7.35	1: 0,828
	/ 8.02+GV80/6.20	Larga High 1: 0,818 Normal 1: 0,632		/ 7.41	1: 0,844
S5-90GP	/ GPA	1: 1,335		/ 7.53	1: 0,833
	/ 6.37	1: 0,975	S6-80	/ 7.67	1: 0,81
	/ 6.70	1: 0,93		/ 7.67+GV80/6.7	Larga High 1: 0,933 Normal 1: 0,814
	/ 7.0+GV70/7.67	Larga High 1: 0,684 Normal 1: 0,548		/ 7.90	1: 0,788
	/ 7.40	1: 0,843		/ 9.00	1: 0,69
	/ 7.52	1: 0,833		/ 9.00+GV80/5.30	Larga High 1: 1,181 Normal 1: 0,693
S6-65	/ 9.00	1: 0,693		/ 9.00+GV80/7.48	Larga High 1: 0,843 Normal 1: 0,693
	/ 7.97+GV80/6.70	Larga High 1: 0,93 Normal 1: 0,788		/ 9.00+GV80/7.52	Larga High 1: 0,831 Normal 1: 0,693
	/ 9.00+GV80/6.70	Larga High 1: 0,93 Normal 1: 0,693		/ 5.67	1: 1,125
	/ 9.00+GV80/7.52	Larga High 1: 0,831 Normal 1: 0,693		/ 5.74	1: 1,11
S6-66	/ 7.36-1.0	1: 0,783		/ 6.37	1: 1,11
	/ 9.06-1.0	1: 0,624		/ 6.98	1: 0,918
	/ 6.8	1: 0,771		/ 7.03	1: 0,904
	/ 6.8+GV70/5.71	Larga High 1: 0,918 Normal 1: 0,771	S6-90	/ 7.03+GV90/5.67	Larga High 1: 1,125 Normal 1: 0,904
S6-70	/ 7.36	1: 0,717		/ 7.03+GV90/5.74	Larga High 1: 1,103 Normal 1: 0,9
	/ 7.92	1: 0,662		/ 7.40	1: 0,863
	/ 9.03	1: 0,581		/ 9.01	1: 0,705
	/ 9.59	1: 0,548		/ 9.01+GV90/7.40	Larga High 1: 0,859 Normal 1: 0,707
S6-75	/ 6.70+GV80/7.52	Normal 1: 0,93 Corta Low 1: 0,831		6S800TO/6.58-0.78 (Volvo ZTO 1006)	1: 0,795
S6-80	/ 5.03	1: 1,17		6S1000/1005 TO/6.75-0.78	1: 0,795
	/ 5.66	1: 1,11		6S1200TD/7.72 - 1.00	1: 0,81
				6S1200TO/6.75 - 0.83	1: 0,93
				6AS1000TO/6.75 - 0.78	1: 0,795
				6AS800TO/6.58 - 0.78	1: 0,795

S5-50/90, S6-65/66/70/75/80/90, 6S-800/1000/1200 TD/TO
(Volvo ZTO 1006), 6AS 800/1000TO

Posterior Neumático Reforzado, girado
Rear Pneumatic Heavy Duty, Rotated

Anexo III Attachment III

	CAJA GEARBOX	RELACIÓN RATIO
	/ 5.30	1: 0,849
	/ 5.50	1: 0,8
	/ 6.20	1: 0,709
	/ 6.61	1: 0,663
S5-50	/ 6.61+GV80	Larga High 1: 0,828
	/ 5.30	Normal 1: 0,663
	/ 8.02	1: 0,549
	/ 8.02+GV80/6.20	Larga High 1: 0,709
		Normal 1: 0,547
S5-90GP	/ GPA	1: 1,157
	/ 6.37	1: 0,845
	/ 6.70	1: 0,806
	/ 7.0+GV70/7.67	Larga High 1: 0,593
		Normal 1: 0,475
	/ 7.40	1: 0,731
	/ 7.52	1: 0,722
S6-65	/ 9.00	1: 0,601
	/ 7.97+GV80/6.70	Larga High 1: 0,806
		Normal 1: 0,683
	/ 9.00+GV80/6.70	Larga High 1: 0,806
		Normal 1: 0,601
	/ 9.00+GV80/7.52	Larga High 1: 0,72
		Normal 1: 0,601
S6-66	/ 7.36-1.0	1: 0,679
	/ 9.06-1.0	1: 0,541
	/ 6.8	1: 0,668
	/ 6.8+GV70/5.71	Larga High 1: 0,796
		Normal 1: 0,668
S6-70	/ 7.36	1: 0,621
	/ 7.92	1: 0,573
	/ 9.03	1: 0,503
	/ 9.59	1: 0,475
S6-75	/ 6.70+GV80/7.52	Normal 1: 0,806
		Corta Low 1: 0,72
S6-80	/ 5.03	1: 1,014
	/ 5.66	1: 0,962

	CAJA GEARBOX	RELACIÓN RATIO
	/ 5.66+GV80/7.52	Larga High 1: 0,959
		Normal 1: 0,723
	/ 6.10	1: 0,894
	/ 6.7	1: 0,806
	/ 6.7+GV80/5.30	Larga High 1: 1,023
		Normal 1: 0,806
	/ 6.90	1: 0,67
	/ 7.35	1: 0,718
	/ 7.41	1: 0,732
	/ 7.53	1: 0,722
S6-80	/ 7.67	1: 0,702
	/ 7.67+GV80/6.7	Larga High 1: 0,809
		Normal 1: 0,706
	/ 7.90	1: 0,683
	/ 9.00	1: 0,598
	/ 9.00+GV80/5.30	Larga High 1: 1,023
		Normal 1: 0,601
	/ 9.00+GV80/7.48	Larga High 1: 0,731
		Normal 1: 0,601
	/ 9.00+GV80/7.52	Larga High 1: 0,72
		Normal 1: 0,601
	/ 5.67	1: 0,975
	/ 5.74	1: 0,962
	/ 6.37	1: 0,962
	/ 6.98	1: 0,796
	/ 7.03	1: 0,784
S6-90	/ 7.03+GV90/5.67	Larga High 1: 0,975
		Normal 1: 0,784
	/ 7.03+GV90/5.74	Larga High 1: 0,956
		Normal 1: 0,78
	/ 7.40	1: 0,748
	/ 9.01	1: 0,611
	/ 9.01+GV90/7.40	Larga High 1: 0,745
		Normal 1: 0,612
	6S800TO/6.58-0.78 (Volvo ZTO 1006)	1: 0,689
	6S1000/1005 TO/6.75-0.78	1: 0,689
	6S1200TD/7.72 - 1.00	1: 0,702
	6S1200TO/6.75 - 0.83	1: 0,806
	6AS1000TO/6.75 - 0.78	1: 0,689
	6AS800TO/6.58 - 0.78	1: 0,689